

REV	ECN NO.	DESCRIPTION	APPROVED BY	DATE
A		PROPOSAL DRAWING	JASON MENG	2010-05-24

**SPECIFICATION**

- A: MATERIAL:**  
 1. HOUSING: PBT WITH 30%GF UL 94V-0  
 2. TERMINAL: COPPER ALLOY, TIN PLATED  
 3. METAL CLIP: TINPLATE
- B: CHARACTERISTICS:**  
 1. RATING: 10A 250V~ ENEC CCC VDE  
 15A 250V~ UL CUL  
 2. INSULATION RESISTANCE: OVER 100M MIN, AT 500V DC  
 3. ELECTRIC STRENGTH: AC 2000V FOR ONE MINUTE
- C: APPROVALS:**  
 UL, VDE, CCC, ENEC

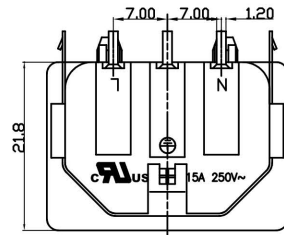
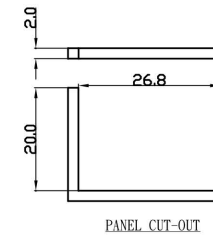
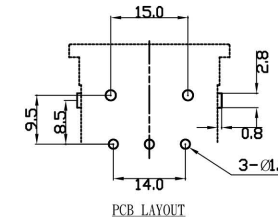
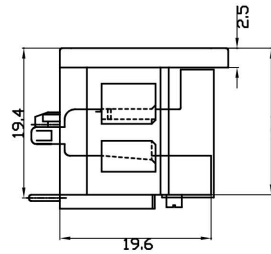
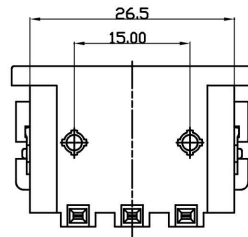
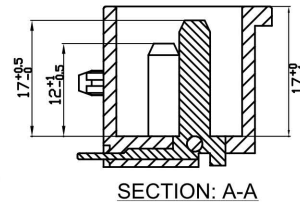
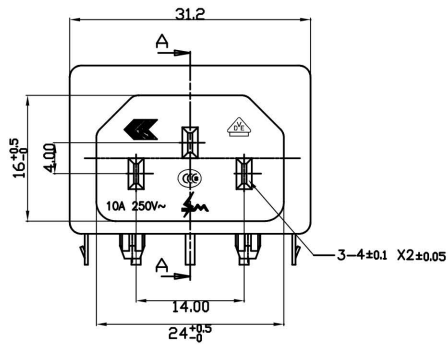

PART NO.	VIEW	DESCRIPTION
11619-202-TM	A	SOLDER WIRE TYPE

DIMENSIONS:  
 MM [INCH]  INCH [MM]  MM ONLY

UNLESS OTHERWISE SPECIFIED, GENERAL TOLERANCE:

DECIMALS ANGLES  
 X. ±0.38 [0.015] X° ±3°  
 .X ±0.25 [0.010] .X° ±1.0°  
 .XX ±0.13 [0.005]

CAD GENERATED DRAWING, DO NOT MANUALLY UPDATE

THIRD ANGLE PROJECTION



TITLE	AC INLEF		
PART NO.	11619-202-TM	APPROVED BY	JASON MENG
DRAWING NO.	11619-202-TM	CHECKED BY	STEVEN LIU
MATERIAL		DRAWN BY	ANNIE WANG
FINISH		GENERATD DATE	2010-05-24
SCALE	NONE	SHEET	1/1
REV.	A	SIZE:A4	FILE NO.:JJJP-A-05-003

DO NOT SCALE DRAWING